



## Contents

Quotation	2
Views of Site	3
Seasonal Shade Projections	4
Summer Shade Projections	5
Terms and Conditions	6
Example Projects	7

## Prepared for

**SSC Corp**  
133 Sydney St  
Sydney

by

**John Smith**  
26 May, 2009

Quotation number 000033



# Quotation

This Shade Audit has  
been prepared using  
WebShade software.



# Quotation

This quotation has been prepared based upon our discussions and understanding of your requirements. Please contact us should you have any questions regarding the proposal.

Product	Description	UOM	Qty	Price	Total
Hypar7.2	SSquare hypar sail	Each	4	8,337.50	33,350.00
<b>PROJECT PRICE</b>					<b>33,350.00</b>
<b>GST</b>					<b>3,335.00</b>
<b>TOTAL PRICE</b>					<b>36,685.00</b>

# Views of Site

Typical view of area



Note bank in distance



View looking south



Road behind location provides good access



# Seasonal Shade Projections

Summer Shade 1.00pm

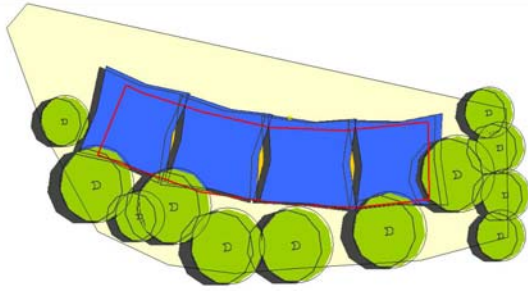

Spring Shade 12.00pm

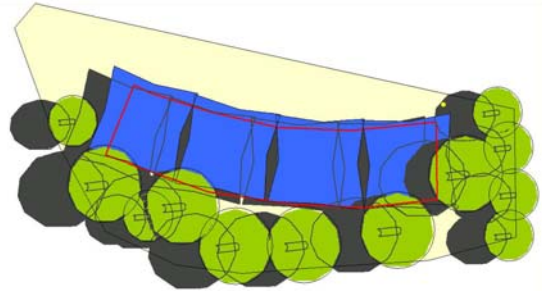

Winter Shade 12 noon

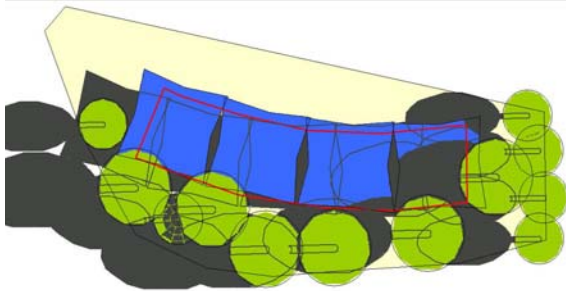

Autumn Shade 12 noon

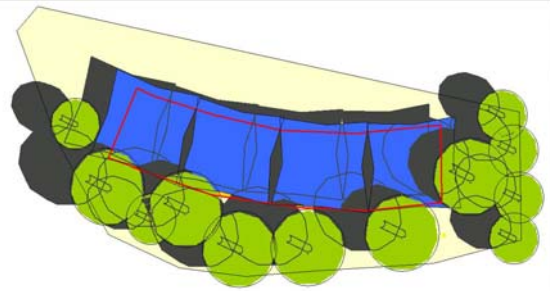



# Summer Shade Projections

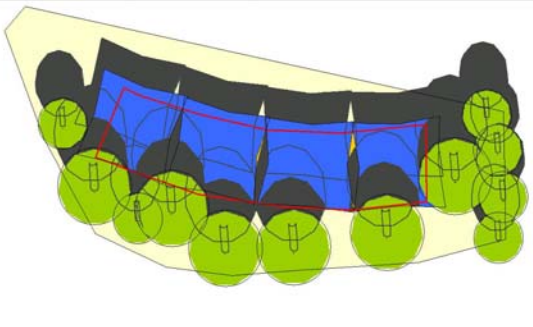

9.00 am

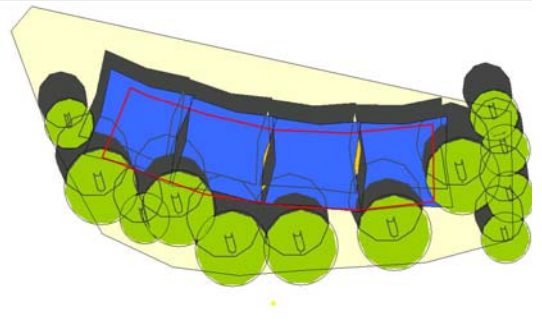

10.00 am

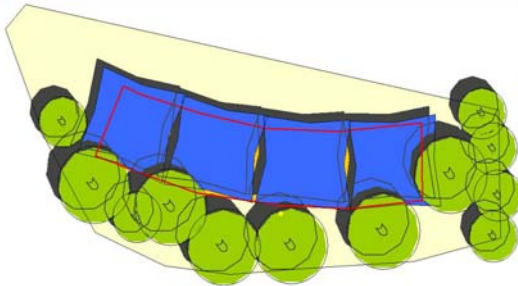

11.00 am

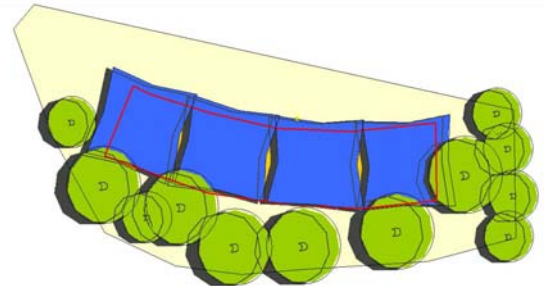

12.00 pm

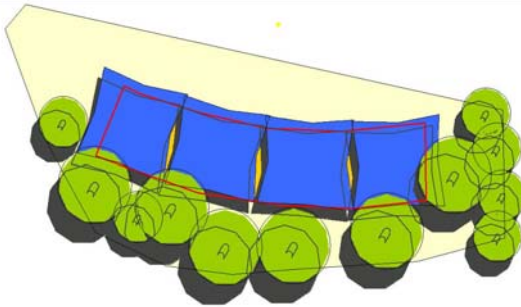

1.00 pm

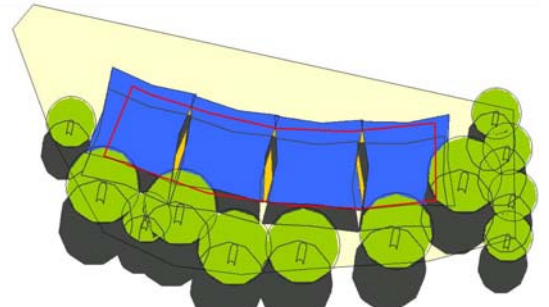

2.00 pm

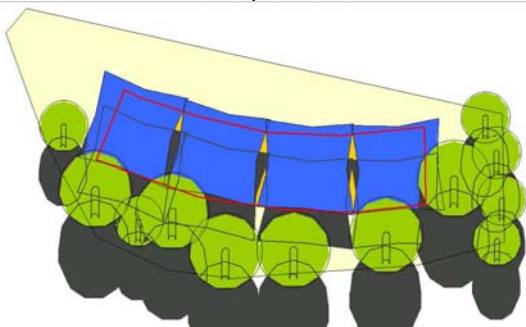

3.00 pm

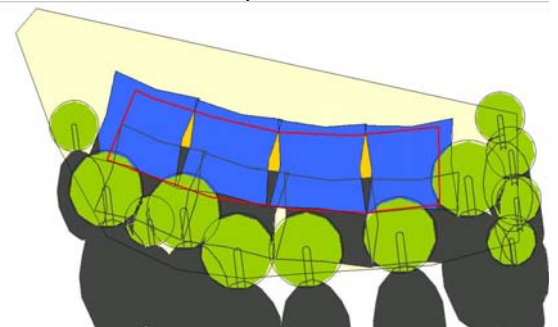

4.00 pm

---

# Terms and Conditions

1. The work will commence upon the receipt of client purchase order.
2. A man day is a capped, 8 hour day. Maximum daily rate is \$960.00 per day, per person.
3. Prices quoted include GST of 10%.
4. Travel abroad will be charged and capped at one day per destination port.
5. Flight delays resulting in additional days at destination ports will also be chargeable.
6. Some tasks maybe undertaken by more than one person, however, only the accumulative number of capped man days will be charged.
7. Payment terms are 7 days from invoice date via electronic transfer.
8. Should the client choose to cancel the work at anytime, the client will inform us in writing of the cancellation and pay all associated costs up to and including the date of cancellation.

# Example Projects

Shade structure developed for NSW Sport and Recreation



View from Northern end



View adjacent to the running track

